

3/4" male NPT fitting with pressure and potable tap.

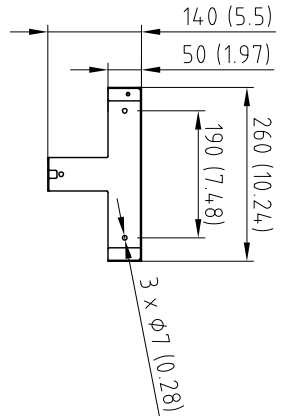

Connection Plate Smart2Pure 3.6

view right side

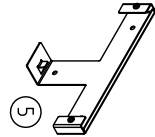
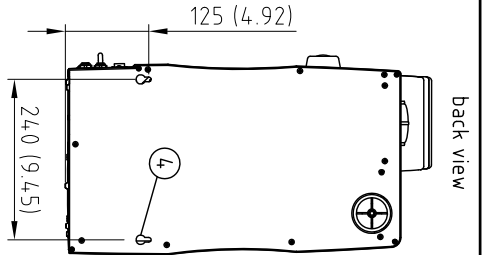
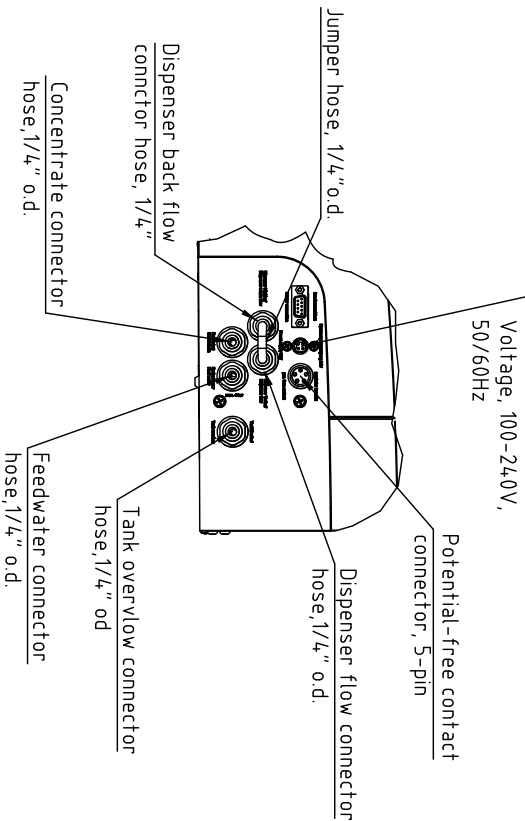
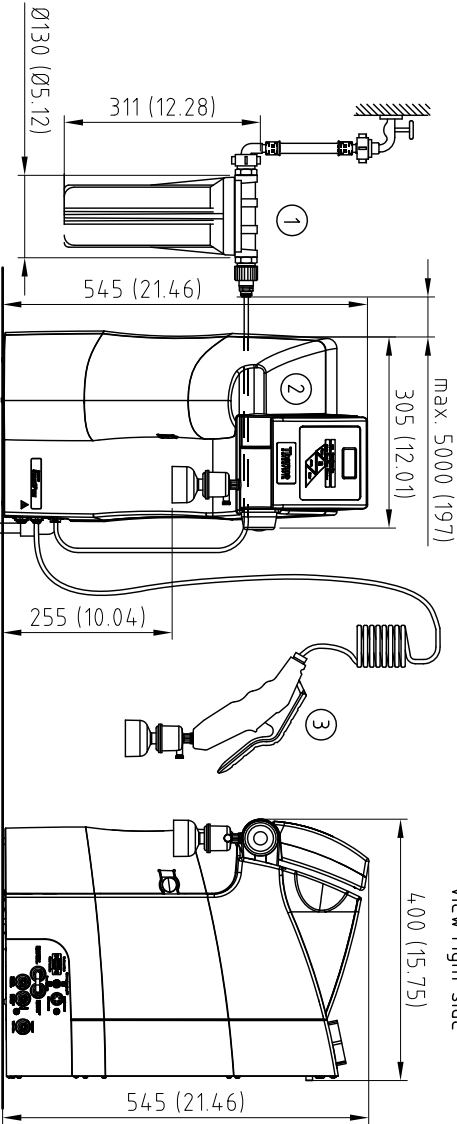

- Legend:
- 1 Barnstead Smart2Pure Single Pretreatment System (Item No. 09.4003)
  - 2 Barnstead Smart2Pure 3 or 6 ultrapure water purification system
  - 3 OPTIONAL Hand Dispenser can be utilized up to 3m (108") from water system
  - 4 Holes are for optional wall mounting of water system with supplied hardware
  - 5 OPTIONAL Wall Mounting Bracket (Item No. 09.2212)

Notes:

- 1 Dual dimensions are in metric and inch

ELECTRICAL REQUIREMENTS		100-240 V, 50/60 Hz, 2-1A, up to 5 ft from unit
WATER CONNECTIONS		3/4" NPT with manual shut off valve recommended
MIN/MAX INLET PRESSURE		15 - 85 PSI (0.1 - 6 bar)
RECOMMENDED FEED TEMPERATURE		2 - 35°C
RECOMMENDED FEED WATER TYPE		Tap/Potable Water
DRAIN		An atmospheric drain must be available within 5 feet of the final mounting location
Client / Town: _____ Project: _____ Scale _____		
Date _____ Name _____		
Drawn 11.09.2014, Avadjeva		
Checked 11.09.2014, OPP		
Thermo Electron LED GmbH, Schwelm 3, D-55672 Niederdorff, Tel. +49 (0)2021 96 99-0		
Dimension sheet		Sheet _____
Pretreatment, Smart2Pure 3.6		Sheets _____
MB112		

Index	Amendment	Date	Name
a	geändert	14.11.2014	M.A
b	geändert	26.11.2014	M.A